

- Min. 20 micron anodized aluminum extruded profile.
- Stainless connectors
- PVC end caps with UV protection
- Transparent or diffused polycarbonate top cover with UV protection
- Cooling capacity up to 14,4 W/m
- Suitable for surface mounting

P W Product & Power Options

Product Name/LED Quantity	Light Color	Input Voltage (V)	Power (W/mt)	Luminous Flux (lm)	Weight (kg)
LLFS860LED	WW-NW-CW	24V DC	4,8	597	0,10
LLFS860LED	WW-NW-CW	24V DC	7,2	881	0,10
LLFS860LED**	WW-NW-CW	24V DC	14,4	1.572	0,10

*Power and Lumen values provided are based off of a coverless product with cold white (CW) LED.
 ** Only WW-NW-CW available.

C Light Color Options

● WW: Warm White 3000K	● R: Red 625nm
● NW: Natural White 4000K	● G: Green 525nm
● CW: Cold White 6500K	● B: Blue 465nm
	● A: Amber 590nm

*Different colors are optional

J Junction Options

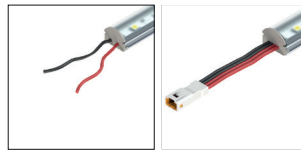

01: Cable (side output)

02: IP Socket (side output)

U Upper Cover Options

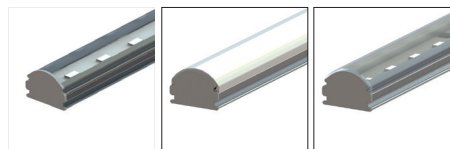

0: Coverless (IP20)

01: Diffused (IP40)

02: Transparent (IP40)

I IP Protection Class



M Mounting Options

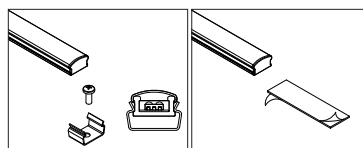

01: Steel Clip

02: Double-Sided Tape



Order Code

P . W . C . J . U . I . M

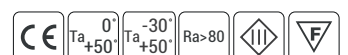

Product Diagrams

Polar Diagram

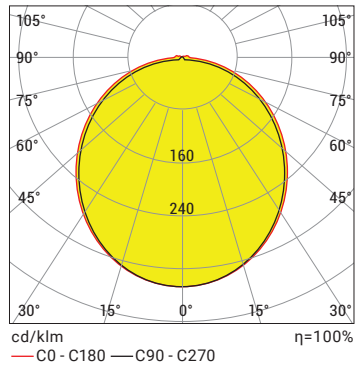





Conical Diagram

H (mt)	Ø (m)	E _{max} (lx)
0.5	1,51	1335
1.0	3,01	334
1.5	4,52	148
2.0	6,02	83
2.5	7,53	53
3.0	9,03	37

LLFS8 60 LED 14,4W CW 120D 24V DC IP40

Control System Options

Color Type	PWM	INV PWM	DMX	DALI	0-10V DC	TRIAC
WW-NW-CW 	•			•	•	
R,G,B,A 	•			•	•	
RGB 						
RGBA/W 						
RGB DMX 						
WHITE DMX 