

- Min. 20 micron anodized aluminum extruded profile
- Stainless connectors
- PVC side cover with UV protection
- UV protective, diffused front cover
- Cooling capacity up to 36W/m
- Suitable for surface mounting

## P W Product & Power Options

Product Name/LED Quantity	Light Color	Input Voltage (V)	Power (W/mt)	Luminous Flux (lm)	Weight (kg)
LLB33 30LED	WW-NW-CW	24V DC	12	765	0,85
LLB33 45LED	WW-NW-CW	24V DC	18	1.110	0,85
LLB33 60LED	WW-NW-CW	24V DC	14,4	1.090	0,85
LLB33 60LED	WW-NW-CW	24V DC	24	1.470	0,85
LLB33 90LED	WW-NW-CW	24V DC	7,2	505	0,85
LLB33 90LED	WW-NW-CW	24V DC	36	2.070	0,85
LLB33 180LED	WW-NW-CW	24V DC	14,4	960	0,85
LLB33 30LED	RGB	24V DC	7,2	-	0,85
LLB33 45LED	RGB	24V DC	10,8	-	0,85
LLB33 60LED	RGB	24V DC	14,4	-	0,85
LLB33 90LED	RGB	24V DC	21,6	-	0,85
LLB33 60LED	RGB/W	24V DC	14,4	-	0,85
LLB33 30LED-DMX	RGB-Pixel	24V DC	8,4	-	0,85
LLB33 45LED-DMX	RGB-Pixel	24V DC	12,6	-	0,85
LLB33 30LED-DMX	RGBW/A-Pixel	24V DC	8,2	-	0,85

\*Power and Lumen values provided are based off of a "cold white (CW) LED".

## C Light Color Options

● <b>WW:</b> Warm White 3000K	● <b>R:</b> Red 625nm	● <b>RGB</b>
● <b>NW:</b> Natural White 4000K	● <b>G:</b> Green 525nm	● <b>RGBW</b>
● <b>CW:</b> Cold White 6500K	● <b>B:</b> Blue 465nm	● <b>RGBA</b>
	● <b>A:</b> Amber 590nm	

\*Different colors are optional

## J Junction Options

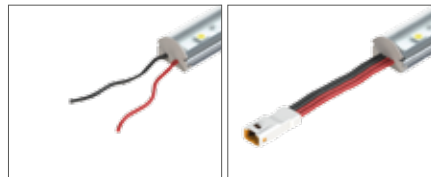

01: Cable \*

02: IP Socket

\*IP66 products are socket only



Order Code

P . W . C . J . U . I . M



## Product Diagrams

### Polar Diagram

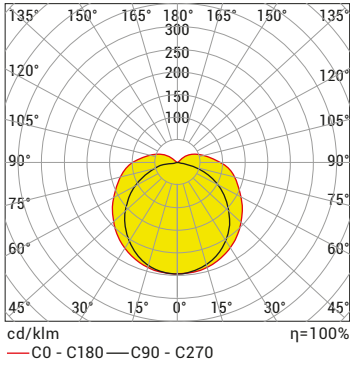

### Conical Diagram

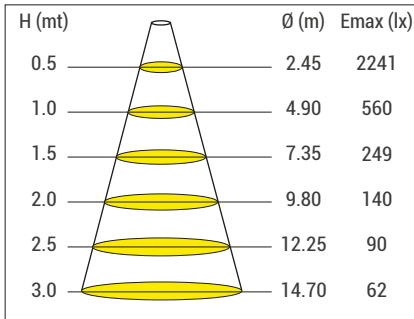

LLB33 90 LED CW 120D 36 W 220V AC IP44D

## U Upper Cover Options

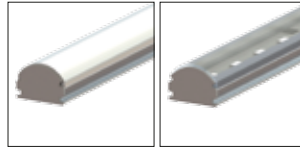

01: Diffused (IP40/IP66)

02: Transparent (IP40/IP66)

## I IP Protection Class



## M Mounting Options

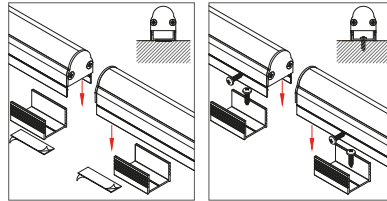

02: Silicone+ Double sided tape

14: Screw mounting

## Control System Options

	Color Type	PWM	INV PWM	DMX	DALI	0-10V DC	TRIAC
WW-NW-CW		•			•	•	
R,G,B,A		•			•	•	
RGB		•					
RGBA/W		•		•			
RGB DMX				•			
WHITE DMX				•			

