

- Min. 20 micron anodized aluminum extruded profile
- Stainless connectors
- ABS end caps with UV protection
- Diffused polycarbonate top cover with UV protection
- Cooling capacity up to 72 W/m
- Suitable for recessed mounting

## P W Product & Power Options

Product Name	Light Color	Input Voltage (V)	Power (W/mt)	Luminous Flux (lm)	Weight (kg)
ERL75	WW-NW-CW	24V DC	36	2.160	2,05
ERL75	WW-NW-CW	24V DC	48	2.880	2,05
ERL75	WW-NW-CW	24V DC	72	4.320	2,05

\*Power and Lumen values provided are based off of a "cold white (CW) LED".

## C Light Color Options

● WW: Warm White	3000K
● NW: Natural White	4000K
● CW: Cold White	6500K

\*Different colors are optional.

## K Cable Direction Options

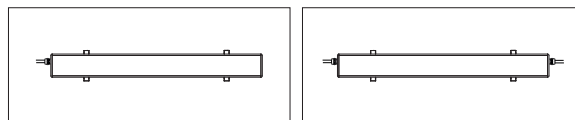

01: Single Entry

03: Dual end exit and entry

## U Upper Cover Options

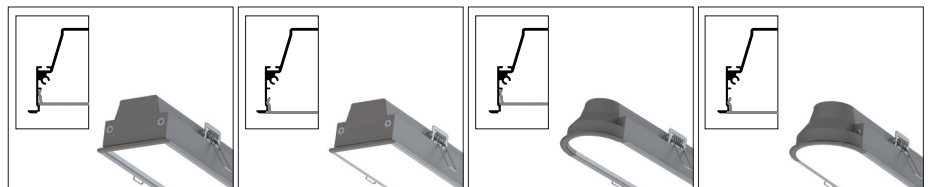

05: Flat Deep Surface

06: Flat Surface

07: Oval Deep Surface

08: Oval Surface



Order Code

P . W . C . K . U

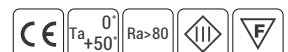

## Product Diagrams

Polar Diagram

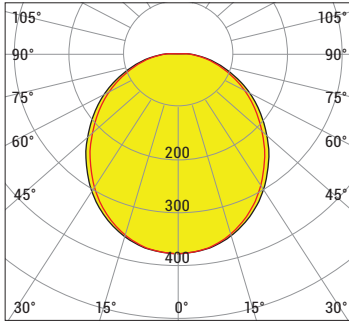

cd/klm  $\eta=100\%$   
 — C0 - C180 — C90 - C270

Conical Diagram

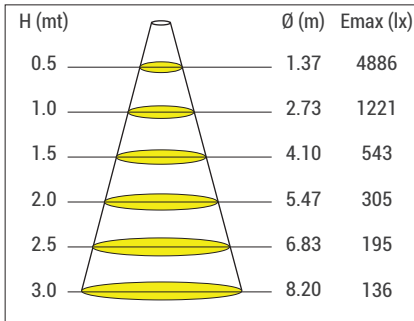

ERL75 CW 120D 72W 24V DC IP44D

## Product Length Options For ERL 75 Flat

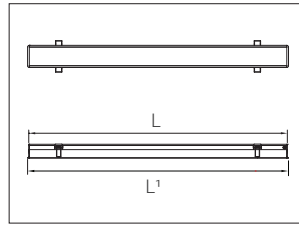

Product Code	*Min. length (L) mm	**Application length mm	Power (W)	Outer Dimension (L1) mm
ERL75	153	133	36	L+14
ERL75	120	100	48	L+14
ERL75	86	66	72	L+14

## Product Length Options For ErRL 75 Oval

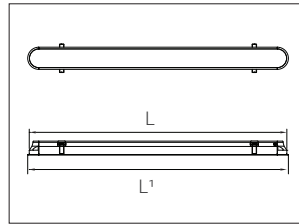

Product Code	*Min. length (L) mm	**Application length mm	Power (W)	Outer Dimension (L1) mm
ERL75	188	133	36	L+14
ERL75	155	100	48	L+14
ERL75	121	66	72	L+14

\*L=product length with end caps.

\*\*Application length formula(L) =min. length +( Application length x Qty )

## Control System Options

Color Type	PWM	INV PWM	DMX	DALI	0-10V DC	TRIAC
WW-NW-CW	•			•	•	
R,G,B,A						
RGB						
RGBA/W						
RGB DMX						
WHITE DMX						

